

DRINKING TROUGH

Drinking Trough & Taps

With outlet fittings configured to your requirements and a 60mm boxed splashback, this drinking trough is ideal for many applications.



KEY FEATURES

- Constructed from 1.2mm 304 grade satin stainless steel
- Left or right hand drain outlets available
- Available in 6 lengths as required, or ask us about custom jobs
- Radius external and internal corners for safety and easy cleaning
- 900mm, 1200mm, 1500mm, 1800mm, 2400mm and 3000mm available off the shelf
- Bubbler fittings include silicone mouthguard
- Choice of lever handle (for young children) or push button dispensing on bubbler and bottle filler
- Simply choose your length of trough, then add your outlets to suit.
- Mix and match to best meet your needs
- Outlets are available pre-plumbed or just on a supply basis for DIY installs.

Suggested mounting height for drinking trough:

- Infant - 550mm
- Primary - 700mm
- Secondary - 900mm

Suggested mounting height for wash trough:

- Infant - 550mm
- Primary - 650mm
- Secondary - 700mm



T-3MSS-BUB90P



T-3MSS-BFL



T-3MSS-BUB90L



T-3MSS-BFP

Model Selection

PWD-900L / PWD-900R	3monkeez Wall-mounted drinking trough 900mm, 304SS, recommend 2 outlets (LH or RH drain)
PWD-1200L / PWD-1200R	3monkeez Wall-mounted drinking trough 1200mm, 304SS, recommend 3 outlets (LH or RH drain)
PWD-1500L / PWD-1500R	3monkeez Wall-mounted drinking trough 1500mm, 304SS, recommend 3 outlets (LH or RH drain)
PWD-1800L / PWD-1800R	3monkeez Wall-mounted drinking trough 1800mm, 304SS, recommend 4 outlets (LH or RH drain)
PWD-2400L / PWD-2400R	3monkeez Wall-mounted drinking trough 2400mm, 304SS, recommend 5 outlets (LH or RH drain)
PWD-3000L / PWD-3000R	3monkeez Wall-mounted drinking trough 3000mm, 304SS, recommend 6 outlets (LH or RH drain)
T-3MSS-BUB90L	3monkeez drinking trough horizontal lever handle bubbler with silicone mouthguard
T-3MSS-BUB90P	3monkeez drinking trough horizontal push button bubbler with silicone mouthguard
T-3MSS-BFL	3monkeez drinking trough horizontal lever handle bottle filler
T-3MSS-BFP	3monkeez drinking trough horizontal push button bottle filler

Your Partner in Cool.

**AQUA
COOLER**

TECHNICAL SPECIFICATIONS

PWD Drinking Trough

- Constructed from 1.2mm 304 grade satin stainless steel
- 150mm boxed splashback
- Tap holes as required
- External and internal corners
- Available pre-plumbed
- Custom sizes available

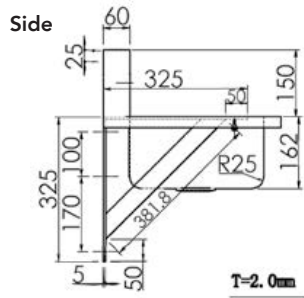

Front

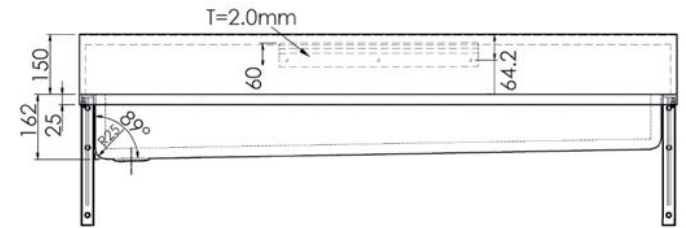

Top

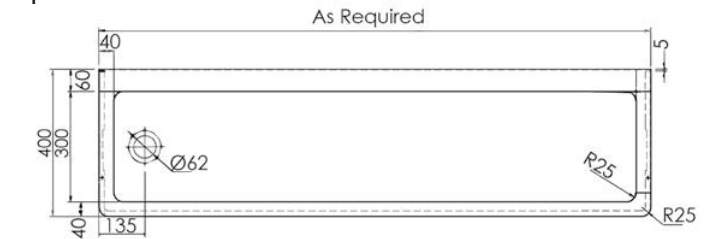

T-3MSS-BUB90P

- Full S/S construction
- Unique silicone mouthguard that protects teeth
- 1/2" FI BSP inlet
- Self-closing valves for water efficiency
- Working pressure range 150kPa-500kPa
- Maximum operating temperature 40 degrees
- WELS 6 Star 1.5LPM

Front

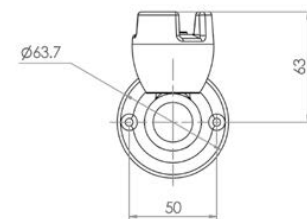

Side

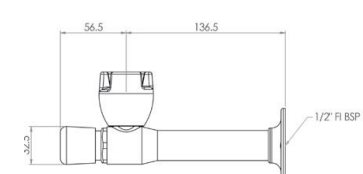

Top

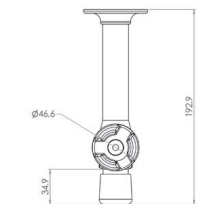

T-3MSS-BUB90L

- Full S/S construction
- Unique silicone mouthguard that protects teeth
- 1/2" FI BSP inlet
- Self-closing valves for water efficiency
- Working pressure range 150kPa-500kPa
- Maximum operating temperature 40 degrees
- WELS 6 Star 1.5LPM

Front

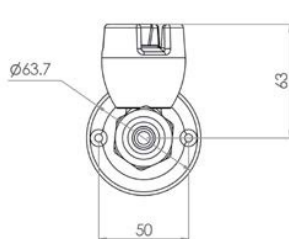

Side

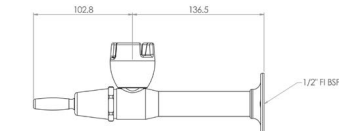

Top

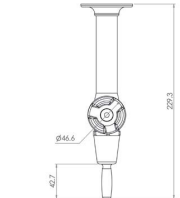

T-3MSS-BFP

- Full S/S construction
- 1/2" FI BSP inlet
- Self-closing valves for water efficiency
- WELS 6 Star 1.5LPM
- Working pressure range 150kPa-500kPa
- Maximum operating temperature 40 degrees

Front

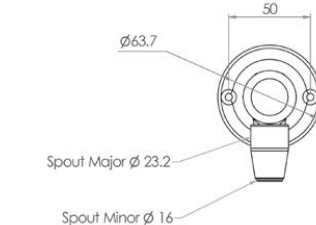

Side

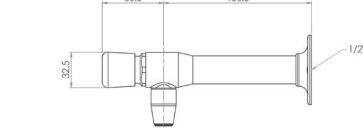

Top

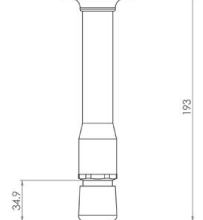

T-3MSS-BFL

- Full S/S construction
- 1/2" FI BSP inlet
- Self-closing valves for water efficiency
- WELS 6 Star 1.5LPM
- Working pressure range 150kPa-500kPa
- Maximum operating temperature 40 degrees

Front

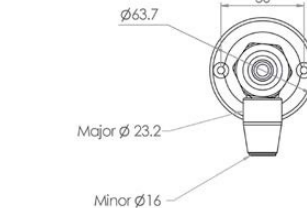

Side

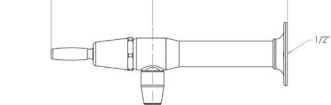

Top

